



Replacement Moving Glass Walls, Window and Doors

**Endless Possibilities to  
Transform Your Home**



# Transformation Made Easy



Why choose Skye Walls? Because we offer everything you need for a whole-home transformation in one team. From state-of-the-art manufacturing to expert installation, flexible financing to first-class warranties, we offer the quality and service you need.

# From Vision To Install, We Handle It All.

Enhance your surroundings with beautiful, high-performing windows and doors. Skye Walls takes care of every part of the process, from the planning to the clean up. Our team of experts are qualified to help you with solutions to meet all of your window and door needs, for projects big or small.

| Included in Base Price:     | SKYE WALLS | Other Installers | Other General Contractors |
|-----------------------------|------------|------------------|---------------------------|
| Expert Consultation         | ✓          | Maybe            | No                        |
| Manufacturer-Direct Product | ✓          | Maybe            | No                        |
| Engineering Services        | ✓          | No               | No                        |
| Permits and Inspections     | ✓          | No               | Maybe                     |
| Demolition                  | ✓          | No               | ✓                         |
| Temporary Wall              | ✓          | No               | ✓                         |
| Moving Electrical           | ✓          | No               | ✓                         |
| Moving Plumbing             | ✓          | No               | ✓                         |
| Framing New Opening         | ✓          | No               | ✓                         |
| Footing Expansion           | ✓          | No               | ✓                         |
| Price of Door               | ✓          | ✓                | No                        |
| Door Installation           | ✓          | ✓                | No                        |
| Drywall                     | ✓          | No               | ✓                         |
| Stucco                      | ✓          | No               | ✓                         |
| Door Warranty/Service       | ✓          | ✓                | No                        |

## One-Company Advantage

- Factory Trained Installers
- Workmanship Guaranteed
- Manufacturer-Direct Pricing
- End-to-End Support

### Support That Has You Covered

We stay in touch throughout your project to answer questions and keep you updated on delivery and installation dates.

### Pro Performance

Our handpicked engineers, installers, and general contractors receive rigorous screening and training.

### Financing that Fits Most Budgets

Take advantage of special financing programs with such flexible terms as deferred payments and low minimum monthly payments.

### An Industry-Leading Warranty

Your moving glass wall or replacement window from Skye Walls is covered by a lifetime warranty on glass and installation and a 10-year warranty on materials, including locks and hinges.

### We Stand Behind Our Products

Skye Walls and its brands are part of the PGT Innovations family, and we only feature products that meet high standards for design, operation, and quality.





# Our Process

We make the process easy, so you can start enjoying your new view, faster and without the hassle.

- 

**Consultation**  
Our experts guide you through the options that best suit your home, vision, and budget.
- 

**Final Measurement Appointment**  
Our engineers and project managers are here to guide your project to completion safely and efficiently.
- 

**Permits and Paperwork**  
Skye Walls fills out the paperwork, submitting permits where needed and providing you with the appropriate materials for HOA applications.
- 

**Professional Installation**  
Our factory-trained professionals prepare your home to building code requirements and install your products. We are so confident in our work we provide a 100% workmanship guarantee.
- 

**Clean Up and Sign Off**  
Once installation is complete, we'll clean up to leave no trace and do the final walk-through with you to ensure your complete satisfaction.
- 

**Enjoy Your New Way of Living!**  
Relax and enjoy, knowing Skye Walls stands behind our products and our work.

# Our Promise

**Green-Minded Manufacturing**  
Work directly with manufacturers who use high-quality, sustainable materials and recycled products that meet Energy Star qualification standards.



**End-to-End Planning and Design**  
Starting with your vision, our engineers and planners create detailed, customized plans to suit your needs.

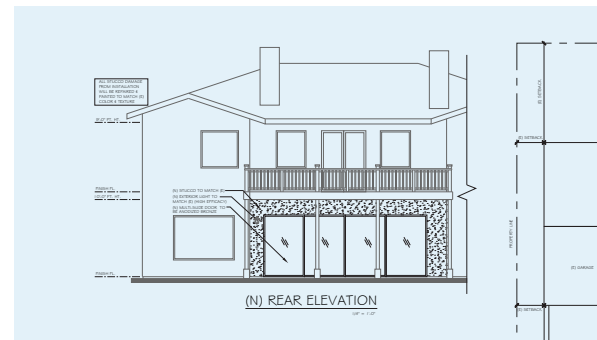

**Quality Guaranteed**  
Skye Walls' brand of our windows and doors are backed by the best warranties and consumer services in the industry.





# Our Family of Brands

Quality and Skill You Can Trust





Windows and doors with endless options, industry-leading warranties, and 5-star consumer-rated service.





Finely crafted overhead doors that offer beauty, safety, and functionality with the right style to fit your home.





High quality windows and moving glass walls that maximize indoor-outdoor living and transform your space.



# Your Experiences

**The Installation Was Perfect**



My wife and I wanted nice sliding glass doors that opened easy enough that our 3-year-old granddaughters could do it. After doing my studies to find a good reliable company, I found Skye Walls. Great Company. From the first phone call, I wanted to do business with this company. The installation was perfect. The door is amazing. I am a very satisfied customer. I highly recommend this company!

Bill, Homeowner - Orange, CA

**I am extremely happy with Skye Walls. I would do it all again tomorrow.**



Great team and work crews. Very caring and responsive. Even after the many beautiful windows they built and installed. I wish I had the room to do more. I am extremely happy with Skye Walls. I would do it all again tomorrow.

Hank, Homeowner - San Diego, CA

# Love for the Home



THE STAR OF ENERGY SAVINGS



Configure and combine our window and door styles to your preference. With high-performance glass, you are protected from the elements and will save energy in our unique west coast conditions. Anlin manufactures high-quality, energy-efficient windows and doors and delivers products engineered to exceed expectations.

- A Anlin Windows & Doors Del Mar Single Hung, Picture Window (White)
- B Anlin Windows & Doors Del Mar Single Slider (White)
- C Anlin Windows & Doors Del Mar Picture Windows (White)
- D Anlin Windows & Doors Del Mar Single Hung, Picture Window, Single Hung (White)

# Explore Your Possibilities with Our Windows and Doors



Repurpose your space with countless configurations and endless glazing and finishing options

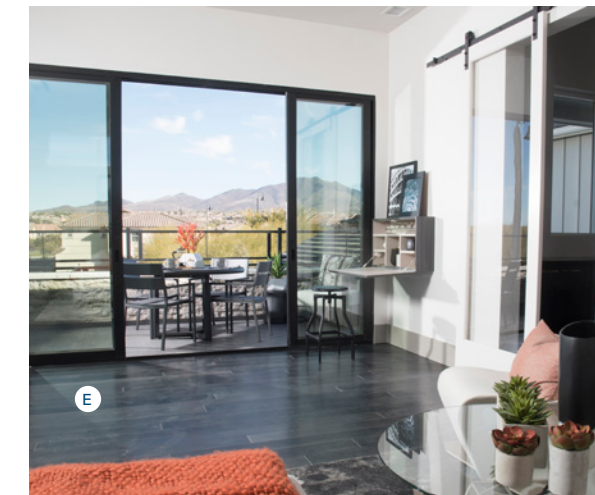

- A Western Window Systems Series 600 Multi-Slide Door (Bronze Anodized)
- B Western Window Systems Series 9550 Bi-Fold Window (Bronze Anodized)
- C Western Window Systems Series 600 Multi-Slide Door (Navajo White)
- D Western Window Systems Series 980 Pivot Door (Bronze Anodized)
- E Western Window Systems Series 600 Sliding Glass Door (Bronze Anodize)



Since 1959, Western Window Systems has been helping people live better through remarkable products that offer the perfect combination of beauty, performance, and durability. Energy efficient and sustainable, our products expand living spaces and connect people to nature and their surroundings, providing an indoor outdoor feel.

# Security and Style

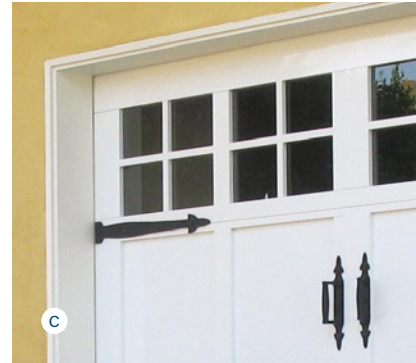
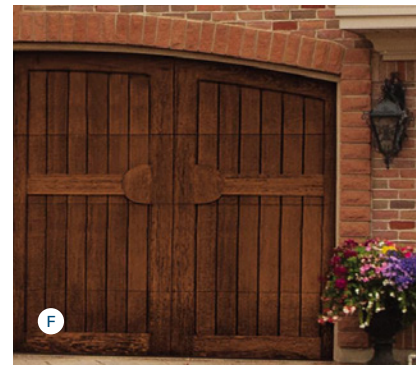
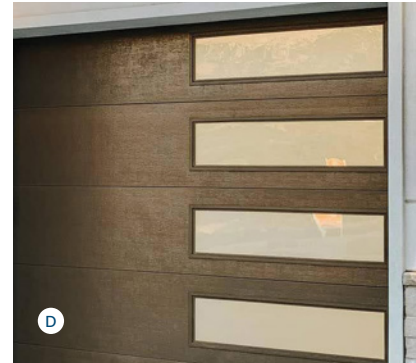
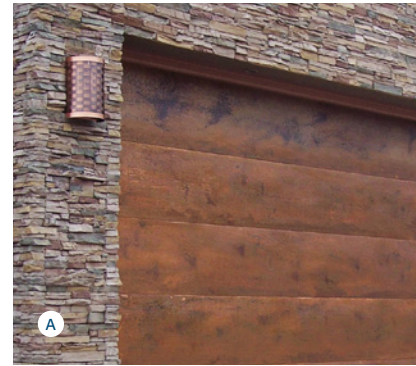

Designing and producing some of the world's finest overhead doors, Martin Door has been helping homeowners transform their homes, finishing them off with style, safety and reliability since 1975. With security and style top of mind, our solutions include safer section joints, protection against the free fall of a garage door in case of a cable break and safer rollers and tracks.

- A** Martin Door Copper Flush No Rib, Commercially Aged
- B** Martin Door Pinnacle Aluminum, Smoked Glass, Sandcast Bronze, Custom Arch
- C** Martin Door Pinnacle Aluminum, Clear Windows, Pure White
- D** Martin Door Cornerstone Flush, Embossed Finish

- E** Martin Door Athen Steel, White Laminate Windows, Traffic White
- F** Martin Door Chalet Dark Barnwood over Dark Barnwood #9009D
- G** Martin Door Pinnacle Steel, Clear Glass, Carbon Black
- H** Martin Door Athena Aluminum, Frosted Glass, Black Gray



[www.glassdreamwalls.com](http://www.glassdreamwalls.com)